

Motor Kit Installation Instructions

- MKL6BTFM -

Powered By **Das-Kit**

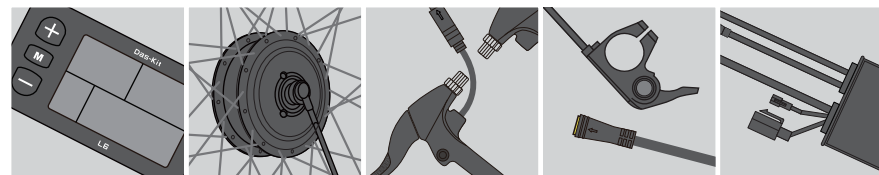

Please read before use!

For Your Safety

When installing this product, be sure to follow the instructions given in the manual!

- It is recommended that you use only genuine parts of the kit at all times. Serious injury may result if loosen or faulty bolts and nuts.
- If the product is improperly adjusted, accidents and serious injury will be occurred.
- Keep this manual in a safe place for later reference.

- When performing maintenance operations (for example parts replacement), be sure to wear goggles or eye protection.
- Please contact us for information on the product not covered by this manual.
- The motor is amoving parts could cause injury, so please kindly take care.
- Giving too much of your attention to the display while riding can lead to an accident.
- It is important to check that the wheels are properly attend to the bicycle before commencing riding. If the wheels are not securely attached fixed serious injury may result.
- When riding a pedal-assisted electric bicycle, you should be fully familiar with the starting-off characteristics of the e-bike before riding it. If the e-bike starts off suddenly, accidents may result.
- It is important to turn on the lights when riding in the evening and at the place in low light situation.
- When cabling the product or installing the parts onto the e-bike, be sure to disconnect the battery. Not doing so may result in electric shock.
- When installing this product, be sure to follow the instructions given in the manual. If bolts and nuts are not tightened correctly or if the product is damaged, the e-bike may suddenly fall over and serious injury may result.
- The frequency of maintenance will vary depending on the usage of the e-bike. The chain should be cleaned periodically using an appropriate chain cleaner. Do not use alkaline or acidic cleaning agents to remove rust under any circumstances. If such cleaning agents are used, they may damage the chain and serious injury may result.

Notes

- Keep the motor and display away from water and heat sources.
- Do not connect positive and negative terminals.
- Keep the kit away from children and pets.
- Do not disassemble any part of the kit.
- Do not subject the kit to shocks (e.g. by dropping).
- In the unlikely event of the kit catching fire, DO NOT attempt to put it out with water. Use sand or another fire retardant instead and call emergency services immediately.
- This product is not intended for use by persons (including children) with reduced physical, sensory or mental capabilities or persons lacking experience and knowledge in using the product.
- Do not modify the system. Doing so may lead to malfunction of the system.
- Please consult the nearest dealer for any errors or problems.
- The product should be avoid wading, flooding when using.
- The vehicle should be parked in the ventilated dry warehouse, should not park in the wet, acid and alkali, also should not coexist with magnetic items.
- When transporting the product on a car in wet weather, put it in a safe place to stop it from getting wet due to the rain. what's more, please add some protector against rain.
- Do not clean the bicycle with a high-pressure water spray. If water gets into any of the components, operation problems or rusting may result.
- The product should not be used for a long time overload, overload.
- Some important information given in this manual may also be found on the product labels.

Das-kit reserves the right to modify the technical data without prior notice.

The picture is for reference only, please be subject to the actual products.

1. Included Components

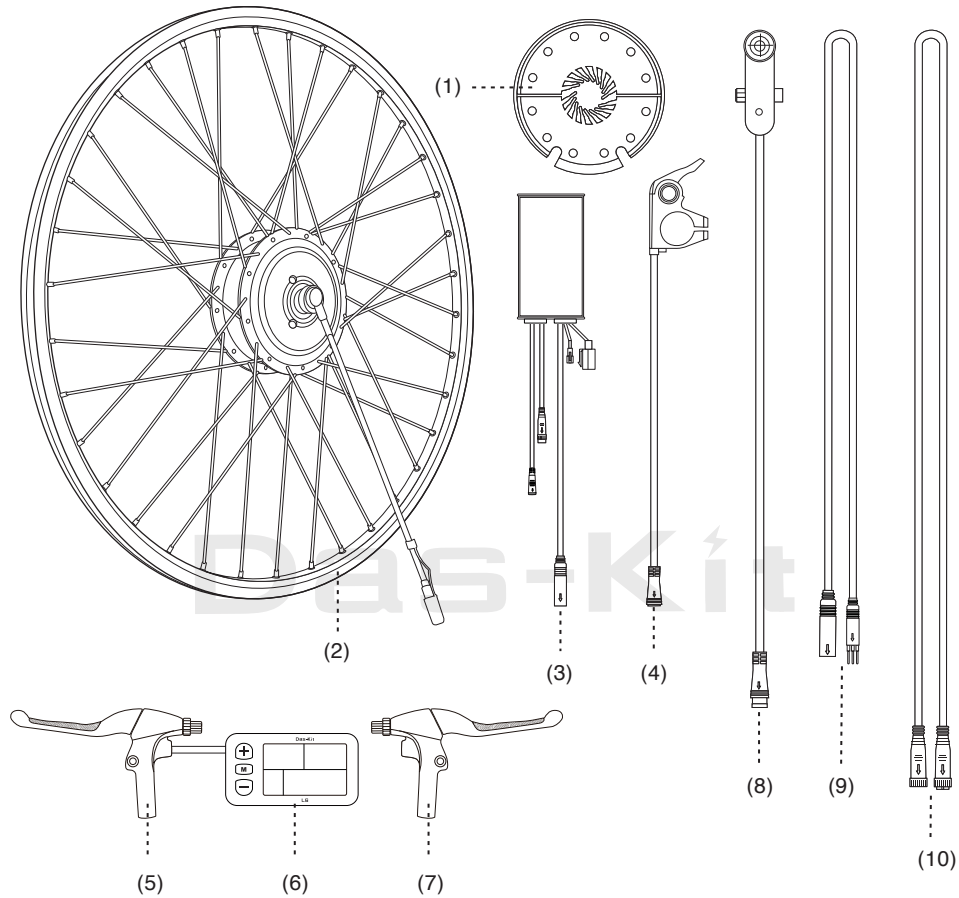

NO.	NAME	NO.	NAME
1	PAS disc	6	Display
2	Motor wheel	7	Right brake lever
3	Controller	8	PAS sensor
4	Throttle	9	Motor connector cable
5	Left e-brake lever	10	Display connector cable

2. Technical Specifications

	MKL6BTFM200SSB18	MKL6BTFM60036SSB	MKL6BTFM70048SSB
Wheel size	20 inches	26 inches	28 inches
Rated voltage	36V	36V	36V
Rated power	250W	250W	250W
Max. torque	≤ 32Nm	≤ 32Nm	≤ 32Nm
Operating temperature	-20~45°C	-20~45°C	-20~45°C

3. Installation Tools You May Need

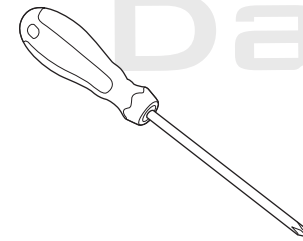

Screwdriver: 75*4mm

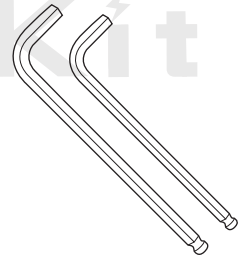

Hex Keys: 5mm&4mm

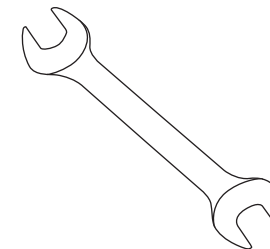

Spanner: 18mm

4. PAS Sensor & PAS Disc Installation

4.1 Mounting options PAS Sensor & PAS Disc:

PAS sensor & PAS disc are for mounting only.
On the left side of the bottom bracket.

The installation is not suitable for the Hollowtec 2 and Octalink bottom brackets shown.
A PAS sensor and a PAS disc are required for the right side.
If one of these bottom brackets is fitted to your bike, please contact customer service (support.au@leoncycle.com).

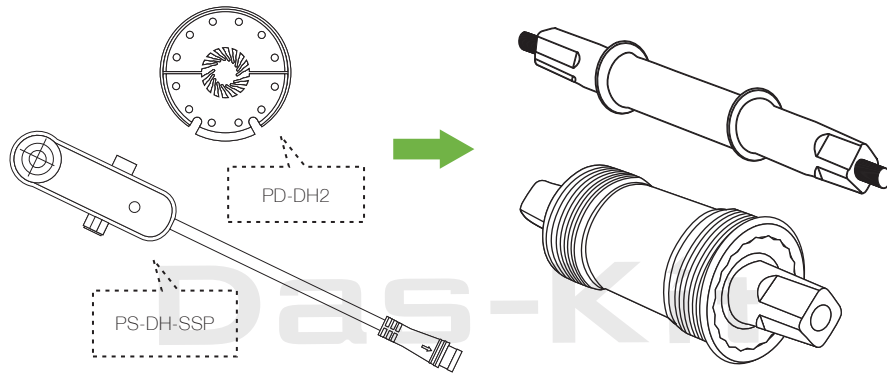

4.2 Mounting PAS Disc

The PAS disc is mounted on the left side of the bottom bracket, the fixation takes place by means of the metal ring.

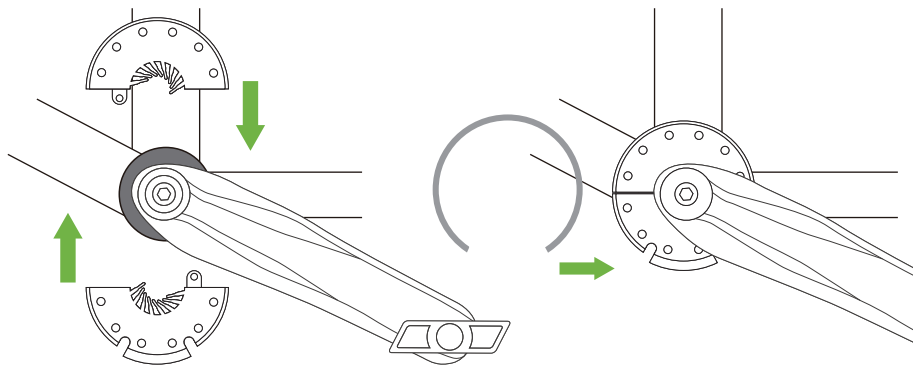

4.3 Mounting the PAS Sensor

The PAS sensor is mounted on the saddle tube or down tube and is secured by cable tie. Please remove the red foil from the back of the PAS sensor to fix it to the seat tube or down tube. The distance between PAS sensor and PAS disc should be approx. 5 mm. Working surface is stamped on one side of the PAS disc, this side must point towards the sensor!

⚠ CAUTION

The PAS sensor must be at the level of the magnets of the PAS disc and run vertically through the centre of the bottom bracket.

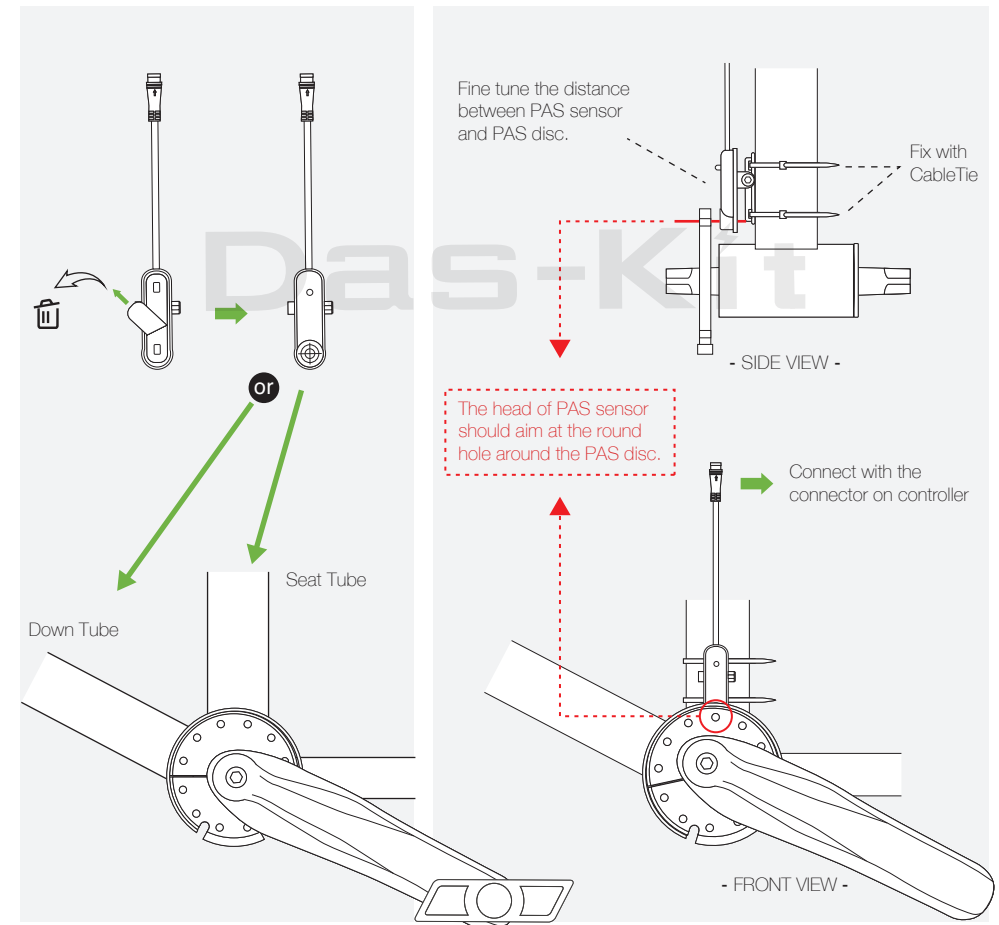

5. Assembly of Handlebar Components

Remove the existing handles and brake levers. Then mount the display (left), the thumb throttle lever (right) and the brake levers and handles. The installation may vary depending on the type of handlebar, so the illustration is an example.

* The tools you may need: 75*4mm screwdriver (for display), 5mm hex key (for brake lever).

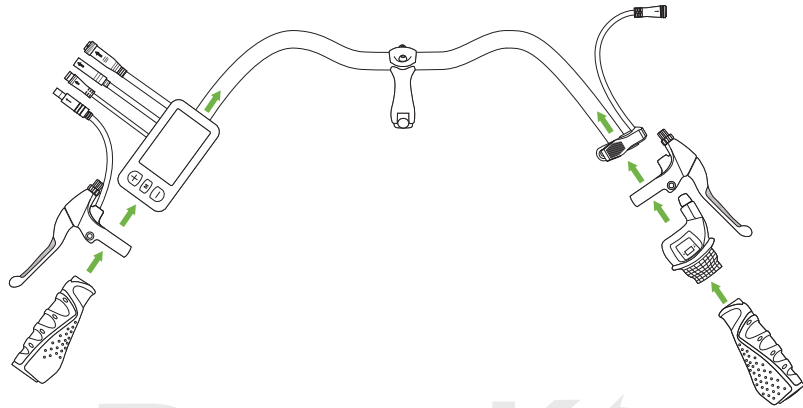

Das-Kit

Connect all cables as shown in the image below. Ensure that the correct cables connect the controller to the motor, display and PAS sensor.

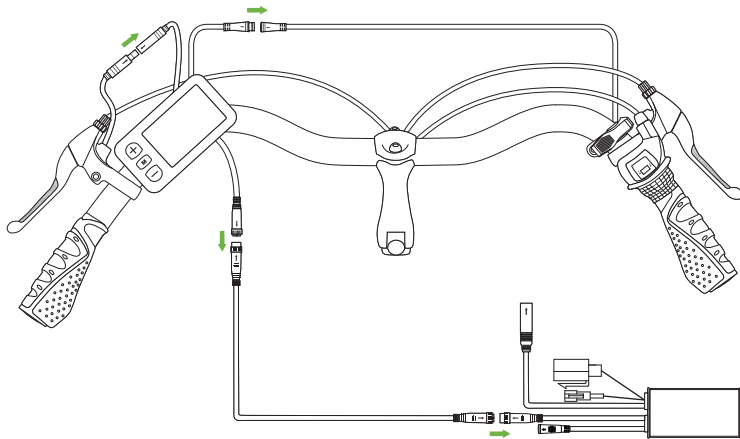

6. Disc Brake Installation

If you use disc brakes on your bike, please follow the instructions on figure 6.1 and 6.2.

If you are using a rim brake, you can ignore the instructions on figure 6.1 and 6.2.

* The tools you may need: 4mm hex key.

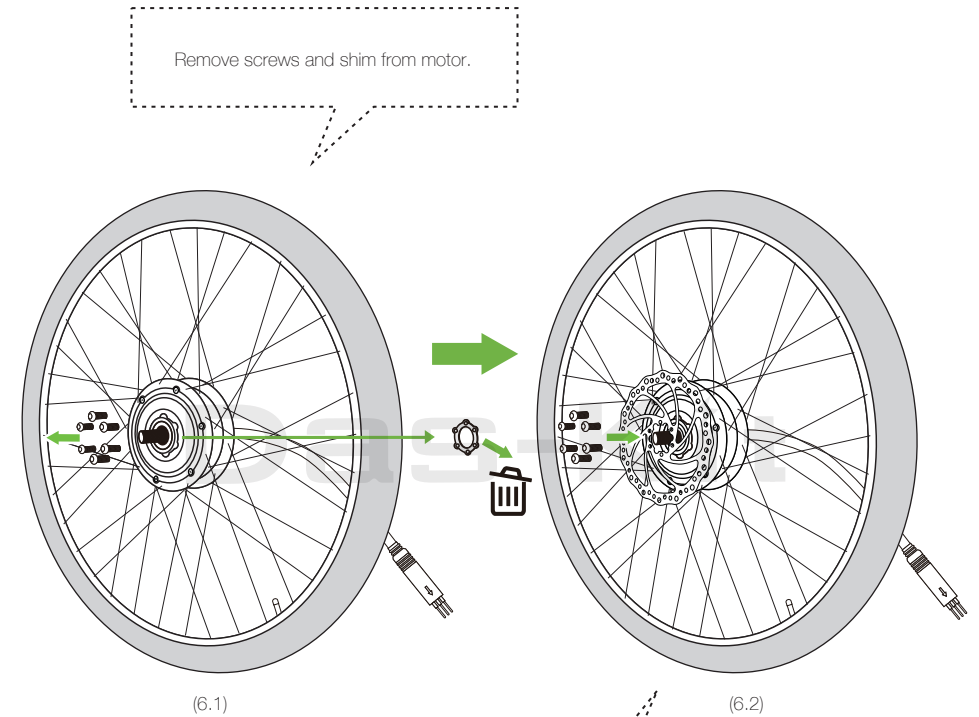

(6.1)

(6.2)

Using the bolts from the previous front motor wheel (without seal)

Remove the disc brake from your previous front wheel and mount them including the screws on your new motor wheel.

7. Tube and Tire Assembly

Please check if all spokes and holes are completely covered by the rim tape. Inflate the hose slightly until it has a round shape, then insert the valve through the hole provided. Please insert the tube into the tire.

⚠ CAUTION

- Do not use any sharp objects for mounting.
- Starting opposite the valve, mount the other side of the tyre on the rim.
- The tube must not be trapped between the tire and the rim.
- Make sure that the valve is in a right-angled position.
- It is best to use a pump with a pressure gauge for inflation.
- The permissible pressure range is indicated on the sidewall of the tire.
- Check the tire pressure at least once a month.

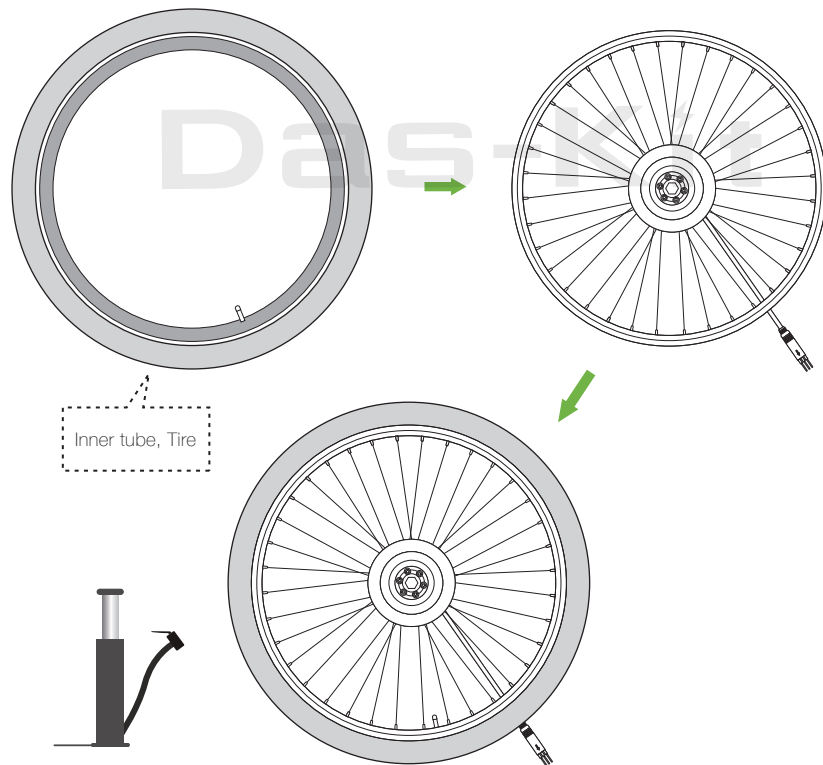

8. Mounting Motorized Front Impeller

Install the impeller with motor as shown in the picture, please refer to step 11. The suit torque should be between 20-40 Nm, please follow the instructions of the manufacturer of your bicycle.

* The tools you may need: 18mm spanner.

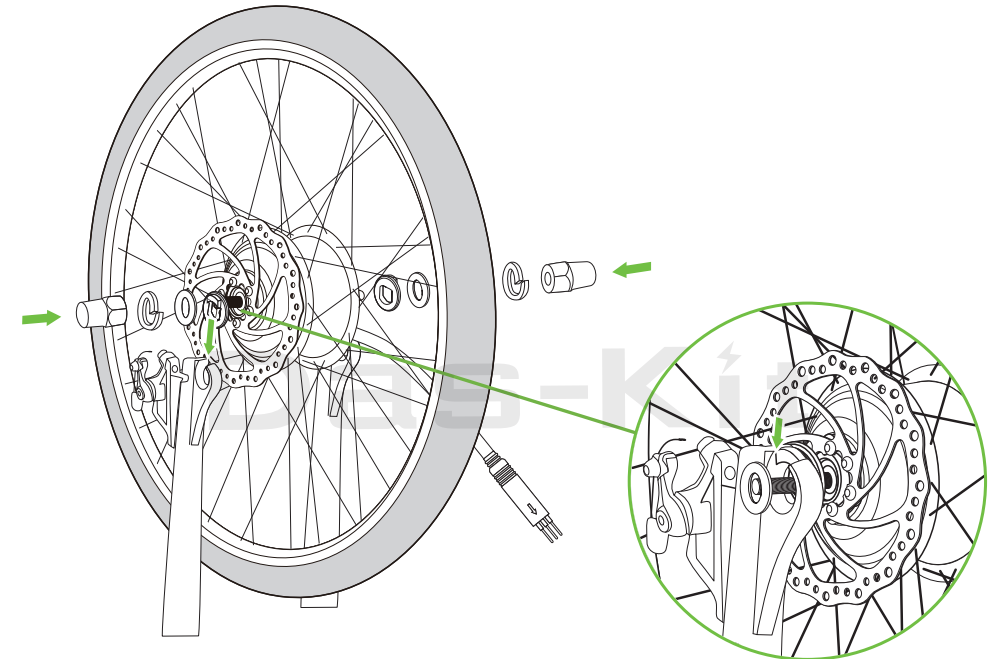

9. Establish Cable Connection

Now connect the cables as shown in the picture.

Please make sure that arrows always point to each other and that the cables are pushed in as far as they will go. Attention the plugs contain partly fine pin connections, proceed cautiously.

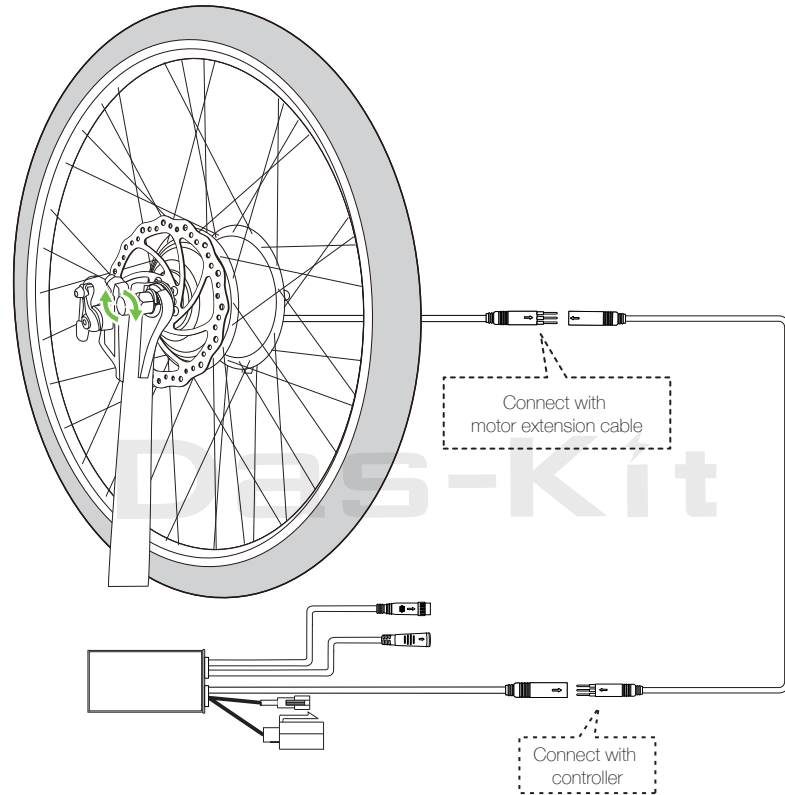

• Controller cable ports indicator

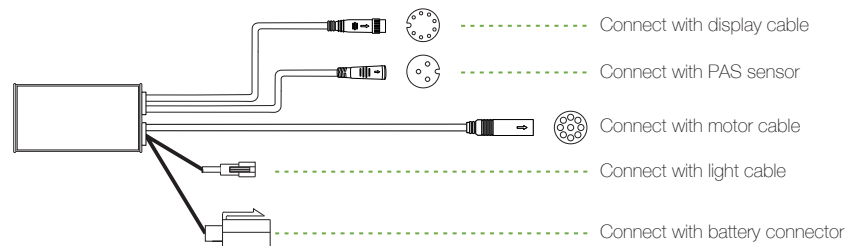

10. System Check

After installation Check your system completely in a traffic-free area, e.g. on a private property. Check first if your brakes are working properly after installation. Please test your brakes before switching on the electric drive. Never test your system before completing all of the steps mentioned above.

Das-Kit

11. Attachment

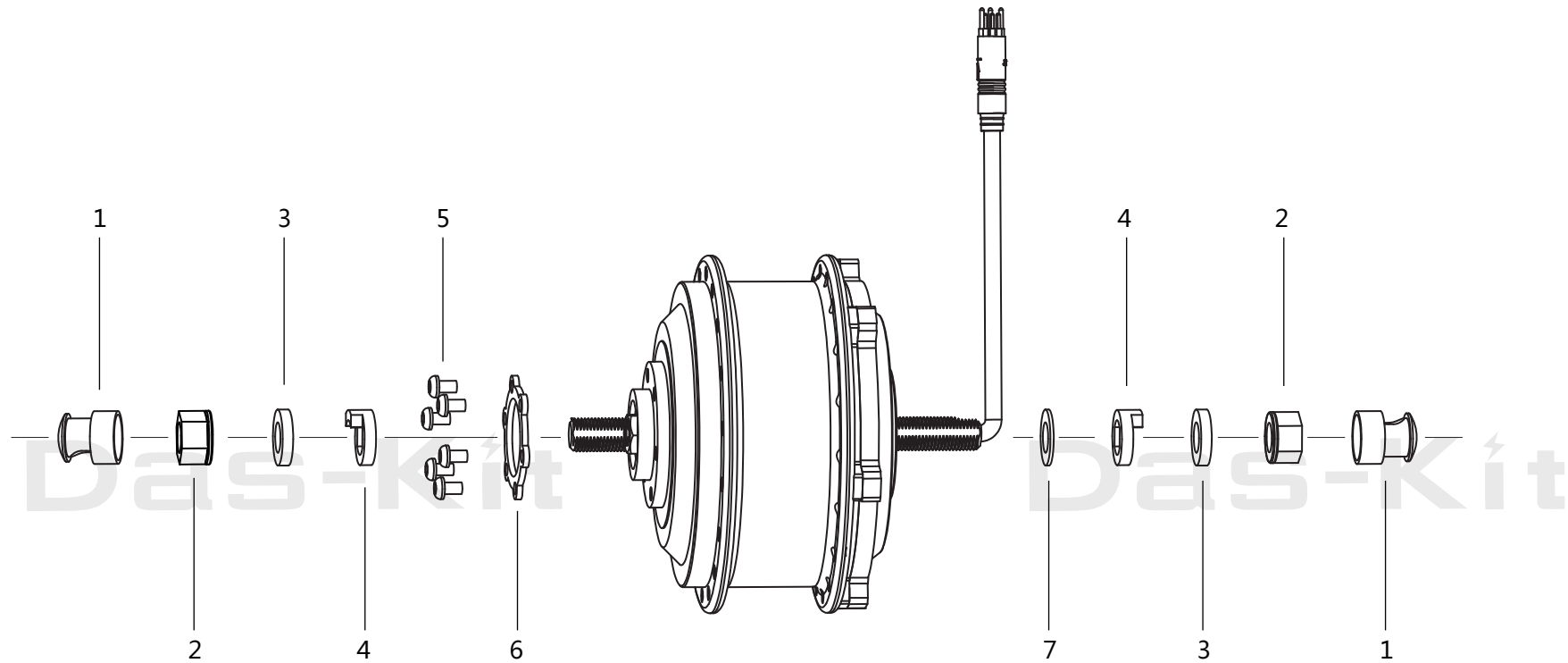

No.	Code	Name	Qty
1	510000116	Decorative cap	2
2	510000118	Hex flange nut	2
3	510000120	2.5mm washer	2
4	510000123	Stop slice	2

No.	Code	Name	Qty
5	510000125	Hexagon socket head screws	6
6	510000124	Disc brake decoration piece	1
7	510000120	2mm washer	1